

CTN WORLD 2011

Key

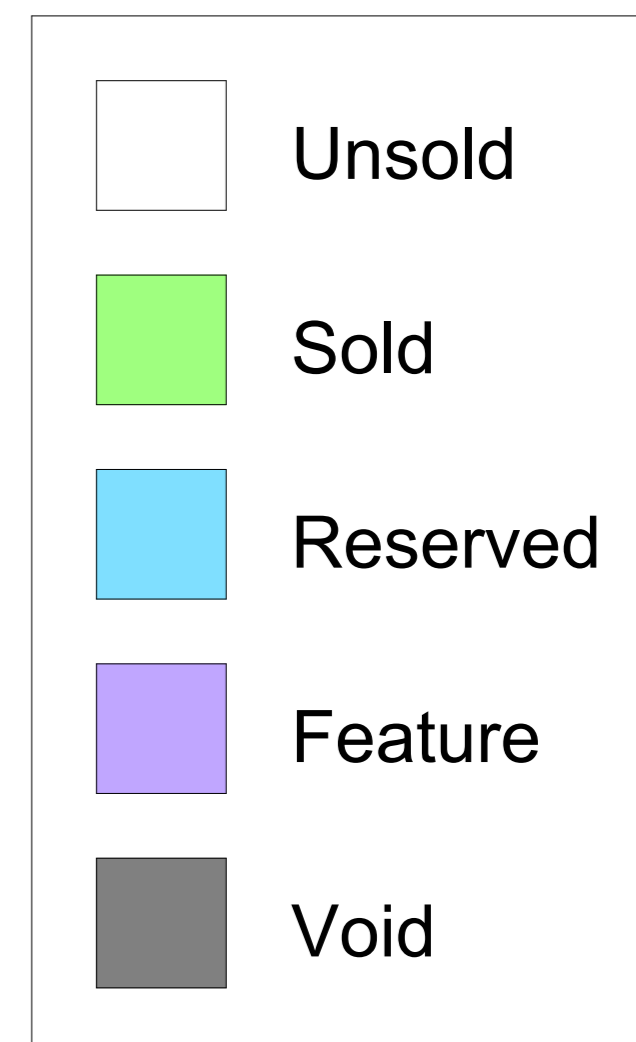

20 - 21 November 2011

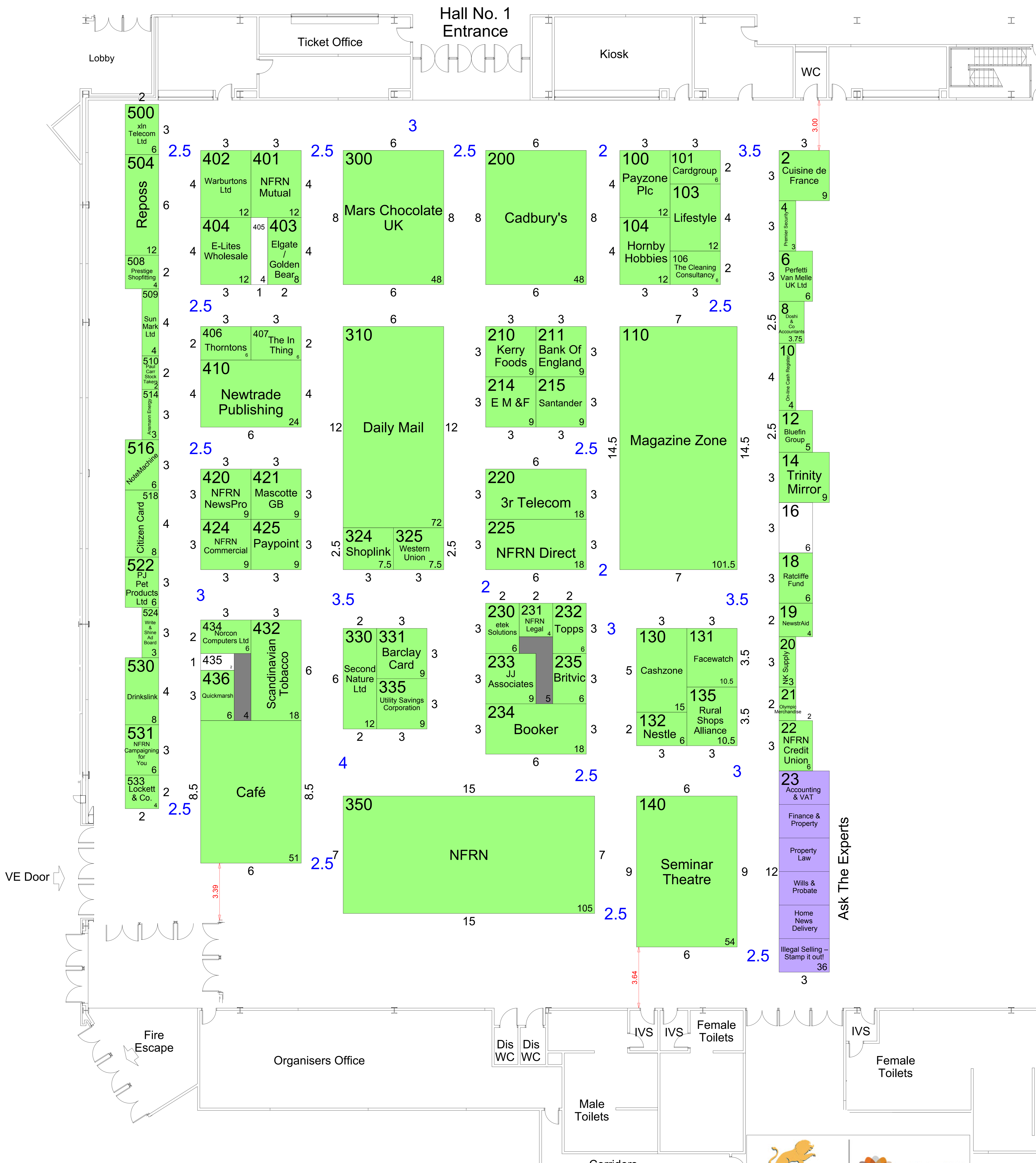

Jaguar Hall

melville **GES**

 GES GLOBAL NETWORK

Issue Number: 667 Updated by: tracy@ctnworld.co.uk

Issue Date: 15 Nov 2011 Scale: N.T.S.

THIS FLOORPLAN IS SUBJECT TO APPROVAL FROM THE VENUE AND LOCAL AUTHORITIES